

Item
Model
ProjectName



DR400

## DR 400

The DR400 waste disposal unit, due to its particular construction and the power of its motor, allows the disposal of all types of kitchen waste (including bones and shellfish shells), as well as pieces of glass and china, excluding metal and plastic. It eliminates the waste products of all sizes and types of catering establishments (canteens, hotels, hospitals etc.) by reducing them to tiny fragments.

## FEATURES

- The frame, the sink and the panelling are in 304 AISI stainless steel.
- Lid in ABS plastic.
- 24 volt control panel on the side of the machine.
- Speed: 1400 revolutions per minute.
- The lid has a microswitch that only allows the machine to function when the lid is perfectly closed.
- Self-braking motor, supplied as standard, which guarantees the immediate stopping of the machine when it is switched off or when the lid is accidentally opened.

**Waste disposal unit**



**DITO**

**Electrolux**

- Emergency stop button to stop the machine whenever necessary.
- Thermal relay to stop the motor if it becomes overloaded.
- Water inlet to the waste disposal unit via a solenoid valve.
- On request, sound-deadening panelling can be supplied to reduce noise levels.
- All models comply with the standards required by the main international approval bodies and are CE marked.

## Specifications

MODEL	DR400 616500
External dimensions - mm	
width	500
depth	700
height	940
Power - kW	
installed-electric	3
Net weight - kg.	132
Supply voltage	380 V, 3, 50



**DITO**

**Electrolux**

## Installation drawings

**616500**

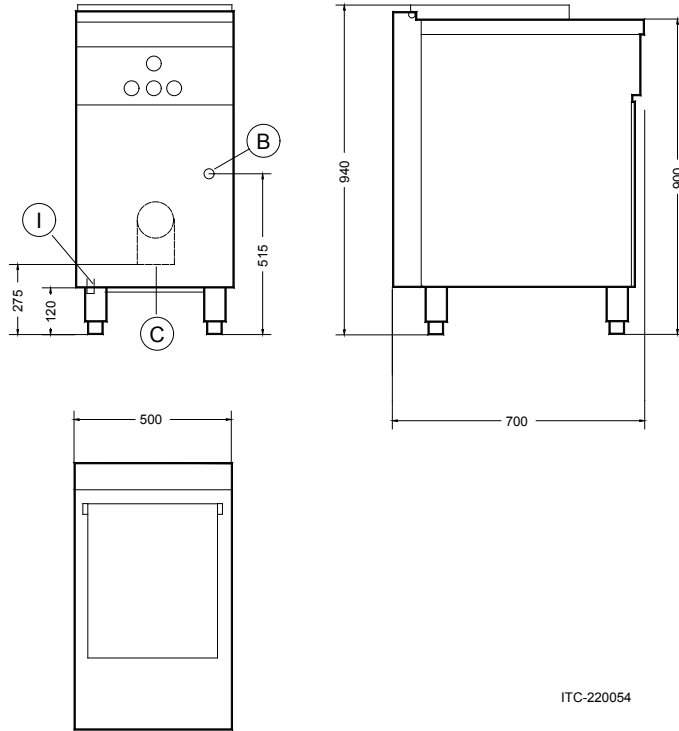

**MODEL**

I - Electrical connection

**DR400  
616500**

380 V, 3, 50

The manufacturer reserves the right to modify and make improvements to the products without giving prior warning. Dimensions, illustrations, technical data, weights, etc. are given as an indication only.



[www.dito-electrolux.com](http://www.dito-electrolux.com)

# Waste disposal unit

ANC010

